

## Patented mounting plug for window handles

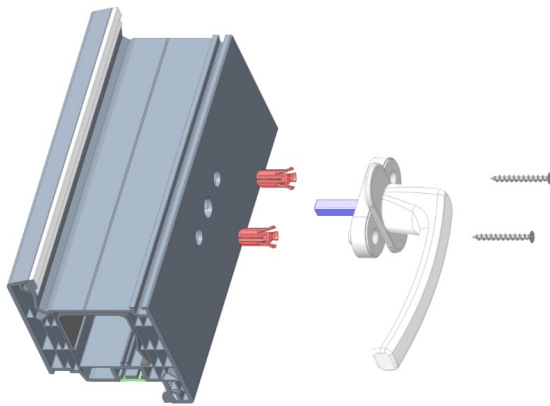

### Overview

**System**  
Window

**Product**  
Roto NX

The universal hardware system for modern windows and balcony doors

**Availability / Ordering ability**  
Available to order now.

**Documentation**  
Installation instructions in the appendix

### Description

**Technical information:**

The chambers of window profiles do not provide any support for the gearbox (for example, by means of a profile strut or appropriately shaped reinforcement).

This is why high backset espagnolette are positioned at an angle when the handle screws are tightened. This results in stiffness in the central locking system.

The mounting plug for window handles now offers a remedy.

The window handle is fixed in the profile with the mounting plug, decoupled from the gearbox, using hardware screws.

If the profile structure permits, the mounting plug can be used with all gearboxes (see profile table).

The profiles specified in the profile table have already been tested. Other profiles can be measured yourself or checked on request.

### Application range:

- Standard handle holes (Ø 10 mm)
- Independent of backset
- Only in conjunction with window handles with positioning pins

## Drilling dimension for window handle

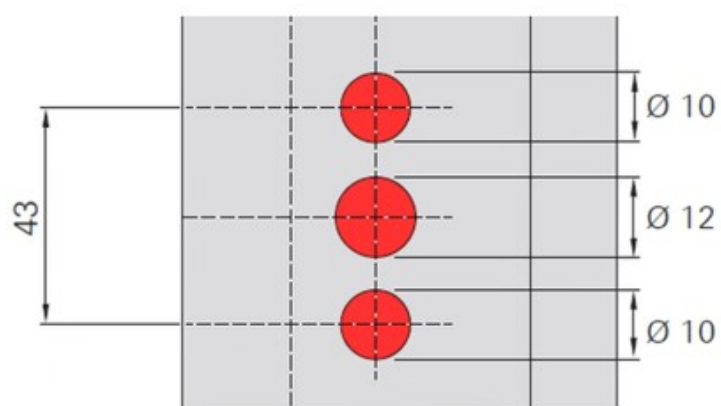

## Dowel length

Dimension	Dowel length
$A < 12 \text{ mm}$	Verification necessary
$B < 25 \text{ mm}$	21 mm

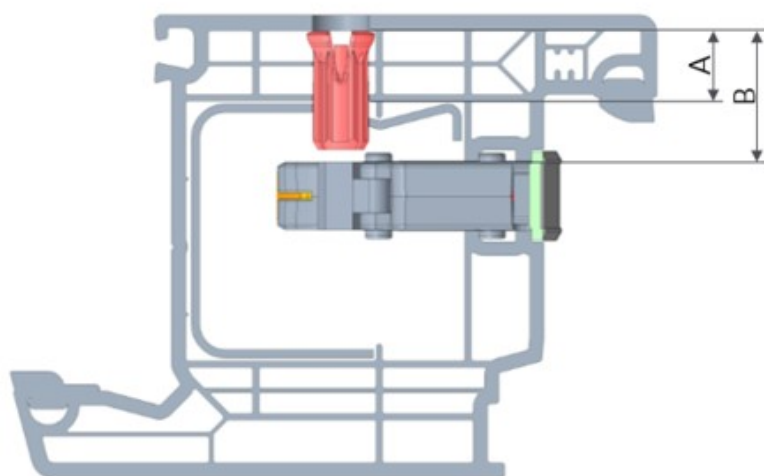

**Please note:**

- Fixing the window handle using window construction screws Ø 4.1 - 4.8 (no M5 screws possible)
- The screw length must be selected so that the screw is turned completely through the anchor (maximum expansion of the anchor)
- tightening torque of the handle screws: approx. 1.5 Nm

**Profile table**

Profile	Dowel length
Aluplast Energeto Neo	21 mm
Aluplast Ideal 5000	21 mm
Deceuninck Elegant	21 mm
Deceuninck 5042	21 mm
Deceuninck 3052	21 mm
Gealan Kontur	21 mm
Profine 76 AD	21 mm
Profine 70 AD	21 mm
Salamander Blue Evolution 82	21 mm
Salamander Streamline 76 MD	21 mm
Schüco Living	21 mm
Veka Softline 82 MD	21 mm
Veka Softline 76 MD	21 mm

**Article Overview**

Article Code	EAN No.	Unit	Material Group
2048464 NX ZB BFD 21MM	4036263578457	100	20

**Roto Frank Fenster- und Türtechnologie GmbH**

Wilhelm-Frank-Platz 1  
70771 Leinfelden-Echterdingen  
Deutschland

# Montageanleitung

*Installation instructions*

Erklärung Bauteile

*Explanation of components*

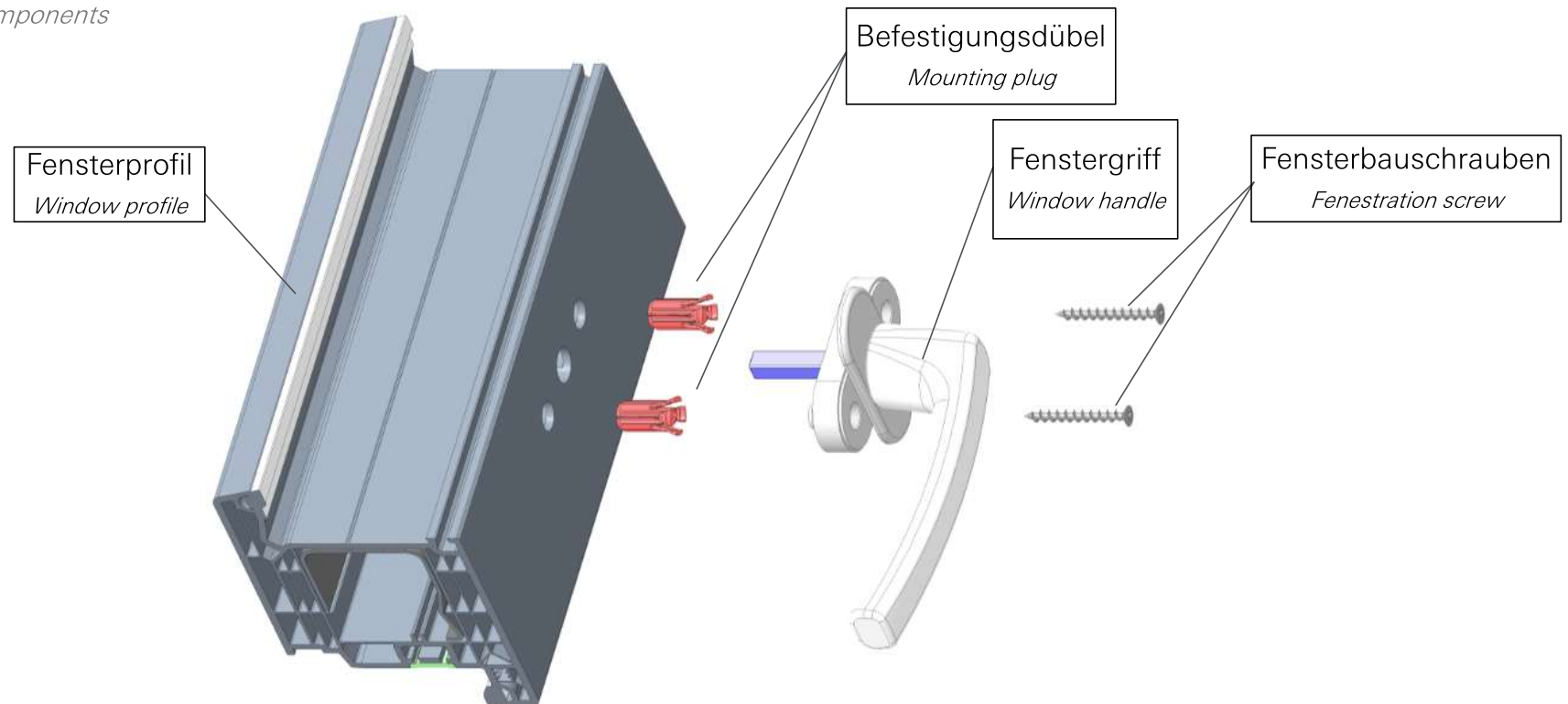

# Montageanleitung

## Installation instructions

### Montagereihenfolge

#### Installation sequence



- Getriebe ist montiert  
*Espagnolette is mounted*
- Dübel ansetzen und eindrücken  
*Insert the dowel and press it in*

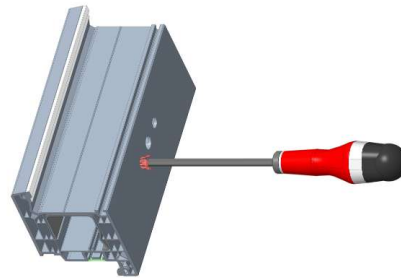

- Dübel mit Hilfsmittel über die 1. Profilwandung drücken / drehen  
*Press/turn the dowel over the first profile wall using a tool*



- Beide Dübel sind montiert  
(Detail siehe nächste Abbildung)  
*Both dowels are installed (see next illustration for details)*

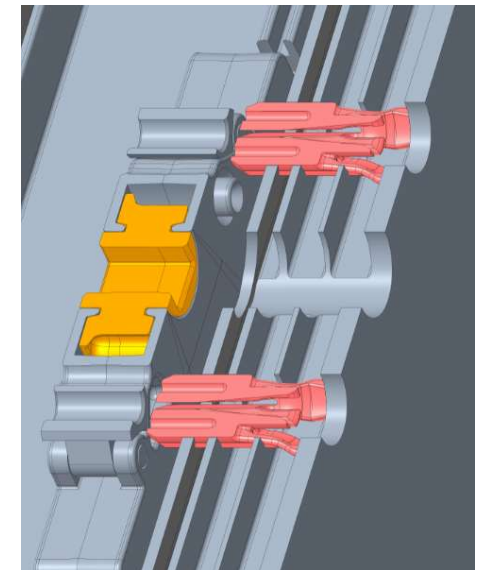

- Dübel hinter der ersten Profilwandung, korrekter Sitz dargestellt  
*Dowel behind the first profile wall correct position shown*

# Montageanleitung

## Installation instructions

### Montagereihenfolge

#### Installation sequence

- Griff wird aufgesteckt und bündig an das Flügelprofil angedrückt

*The handle is attached and pressed flush against the sash profile.*

- Griff mithilfe von Fensterbauschrauben  $\varnothing 4,1 \times \dots$  mm anschrauben  
*Attach the handle using window screws  $\varnothing 4.1 \times \dots$  mm*

- Schraubenlänge so wählen, so dass die Schraube vollständig durch den Dübel gedreht wird (maximale Spreizung des Dübels)  
*Choose a screw length that allows the screw to be fully inserted through the anchor (maximum expansion of the anchor)*

- Anzugsmoment der Griffschrauben: max. 1,5 Nm  
*Tightening torque of the handle screws: max. 1.5 Nm*

